

SMART[®]

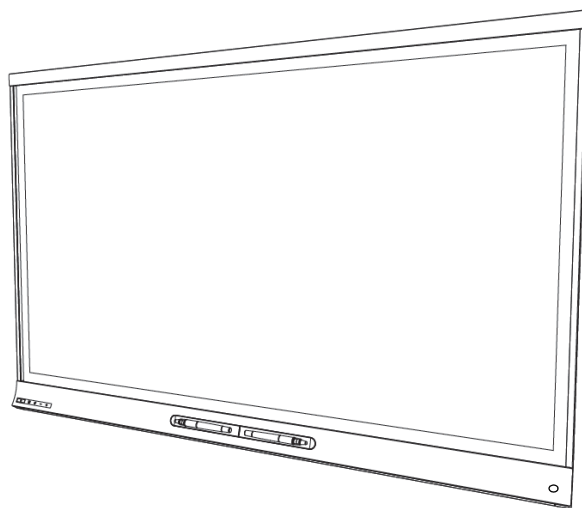

Service Parts Diagrams

For Model:

SPNL-6375P-I5

SPNL-6375P-M3

SPNL-6375P-PENT

Service Parts Diagrams Revision History

Revision 1 - December, 2018

- New document

Standard Warranty Terms

Base product: Three-year limited equipment warranty

First Customer Ship: October, 2018

SMART Technologies

3636 – Research Road NW

Calgary, AB T2L 1Y1

CANADA

Support +1.403.228.5940 or Toll Free 1.866.518.6791 (Canada/U.S.)

Support Fax +1.403.806.1256

www.smarttech.com/contactserviceparts www.smarttech.com

The SMART logo consists of the word "SMART" in a bold, stylized, sans-serif font. The letters are black with a white outline, and a registered trademark symbol (®) is located at the bottom right of the letter "T".

Service Parts Diagrams for the SPNL-6375P-I5/M3/PENT

Identifying Your Product Using the Serial Number 1
Ordering Parts 1
SPNL-6365P-I5/M3/PENT Parts 2

Identifying Your Product Using the Serial Number

To make sure that you have the correct service parts diagrams, you must verify the serial number of your SPNL-6375P-I5/M3/PENT. The serial number of the flat panel display will be located on the right underside of the bottom bezel. The serial number of the AM50 will be located on the top of the appliance. The serial number of the compute card will be located on the bottom of the card. An example of the serial number format is shown below.



Serial Number Location

Unique Serial Number

K032KW40I0004

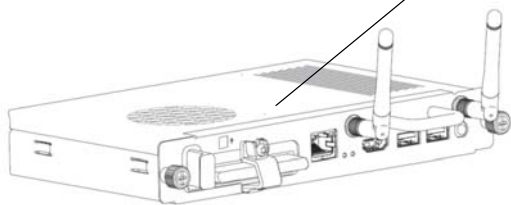

Serial Number Location

Unique Serial Number

F102KW33M00003

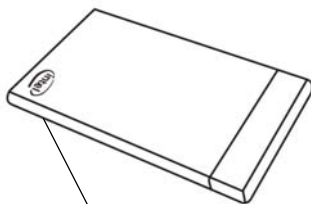

Serial Number Location

Unique Serial Number

G6MK8220000F

Ordering Parts

Customers

To order any of the parts in these service parts diagrams, contact your local reseller. To find a reseller near you, visit www.smarttech.com/where.

Dealers and Distributors

For specific technical and pricing enquiries in regards to these diagrams please contact our service parts department. Pricing is also available on-line via the SOURCE website (source.smarttech.com).

Web Form: www.smarttech.com/contactserviceparts
Phone: 1.888.42.SMART
International: +1.403.245.0333

SPNL-6365P-I5/M3/PENT Parts

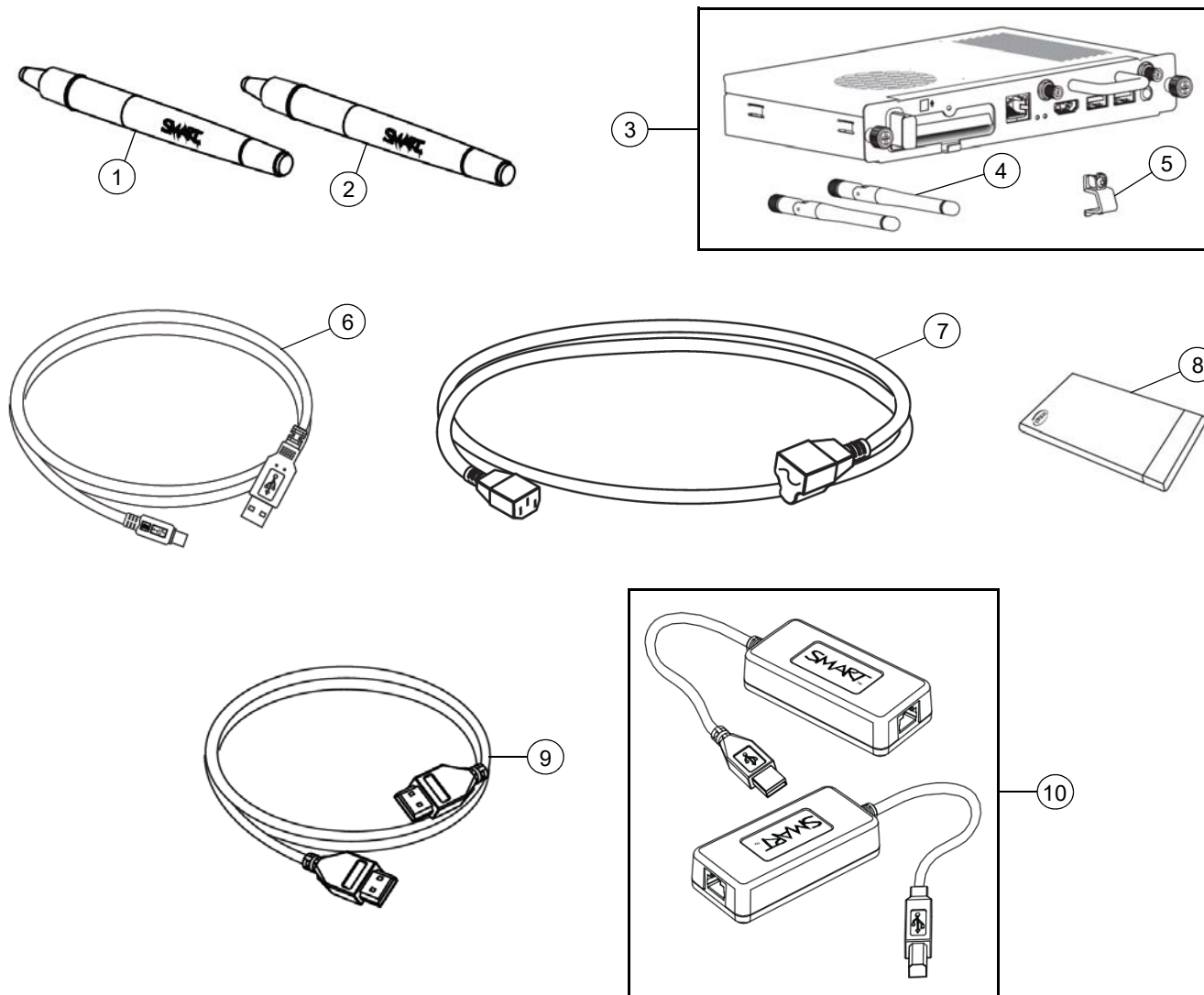

Item	Part No.	Qty	Description
1	1028647	1	Replacement Pen for SPNL-6000 Series and SBID8000-G5 Series - Red
2	1028646	1	Replacement Pen for SPNL-6000 Series and SBID8000-G5 Series - Black
3	1031808	1	Assembly, PC, AM50, ENT NOTE: Includes AM50 and items 4 and 5.
4	1029824	2	Antenna
5	1031640	1	Cover, security, AM50
6	1028289	1	Cable, USB, A-B, 16' (5.0 m)
7	1022063	1	Cable, power, North America, 8' (2.4 m)
7	93-055	1	Cable, power, United Kingdom, 8' (2.4 m)
7	93-056	1	Cable, power, Autstralia, 8' (2.4 m)
7	93-054	1	Cable, power, Europe, 8' (2.4 m)
7	93-00708-20	1	Cable, power, China, 8' (2.4 m)

7	93-00654-20	1	Cable, power, Japan, 8' (2.4 m)
7	93-063	1	Cable, power, South Africa, 8' (2.4 m)
7	1018969	1	Cable, power, Singapore, 14' 9" (4.5 m)
7	1018970	1	Cable, power, India, 14' 9" (4.5 m)
7	1018971	1	Cable, power, Saudi Arabia, 14' 9" (4.5 m)
7	1018972	1	Cable, power, Brazil, 14' 9" (4.5 m)
7	1025597	1	Cable, power, Argentina, 14' 9" (4.5 m)
7	1025603	1	Cable, power, Chile and Italy, 14' 9" (4.5 m)
7	1030859	1	Cable, power, Korea, 8' (2.4 m)
8	1031720	1	Assembly, compute card, Intel, i5 NOTE: Included with SPNL-6375P-I5.
8	1031087	1	Assembly, compute card, Intel, m3 NOTE: Included with SPNL-6375P-M3.
8	1031718	1	Assembly, compute card, Intel, Pentium NOTE: Included with SPNL-6375P-PENT.
9	1019416	1	Cable, HDMI male to HDMI male, 20' 8" (6.3 m)
10	CAT5-XT-1100	1	CAT 5 to USB Extender, CAT5 Cable not included
Not shown	1028215	1	Kit, packaging, SPNL-6375P-I5/M3/PENT