



SMART[®]



Service Parts Diagrams

For Model:

SBID-GX165-V2

SBID-GX175-V2

SBID-GX186-V2

Service Parts Diagrams Revision History

Revision 1 - February, 2023

- New document

Standard Warranty Terms

Base product: Three-year limited equipment warranty

First Customer Ship: December, 2022

SMART Technologies ULC
3636 Research Road NW
Calgary, AB T2L 1Y1
CANADA
www.smarttech.com



© 2023 SMART Technologies ULC. All rights reserved. SMART Board, smarttech and the SMART logo are trademarks or registered trademarks of SMART Technologies ULC in the U.S. and/or other countries. All other third-party product and company names are for identification purposes only and may be trademarks of their respective owners. Contents are subject to change without notice. 02/2023.

Service Parts Diagrams for the SBID-GX165-V2/SBID-GX175-V2/ SBID-GX186-V2

Identifying Your Product Using the Serial Number 1
Service Parts 2

Identifying Your Product Using the Serial Number

To make sure that you have the correct service parts diagrams, you must verify the serial number of your display. The serial number of the flat panel display will be located on the left side.

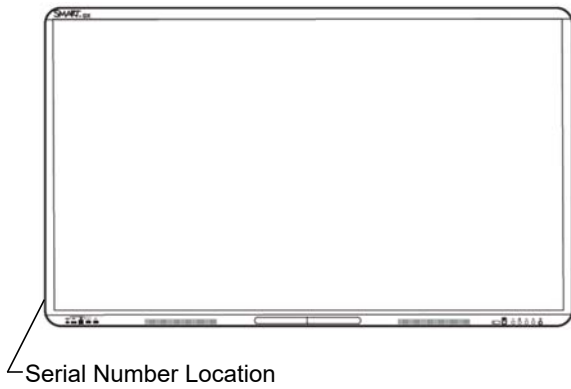

Unique Serial Number

F122OW48W0094

Service Parts

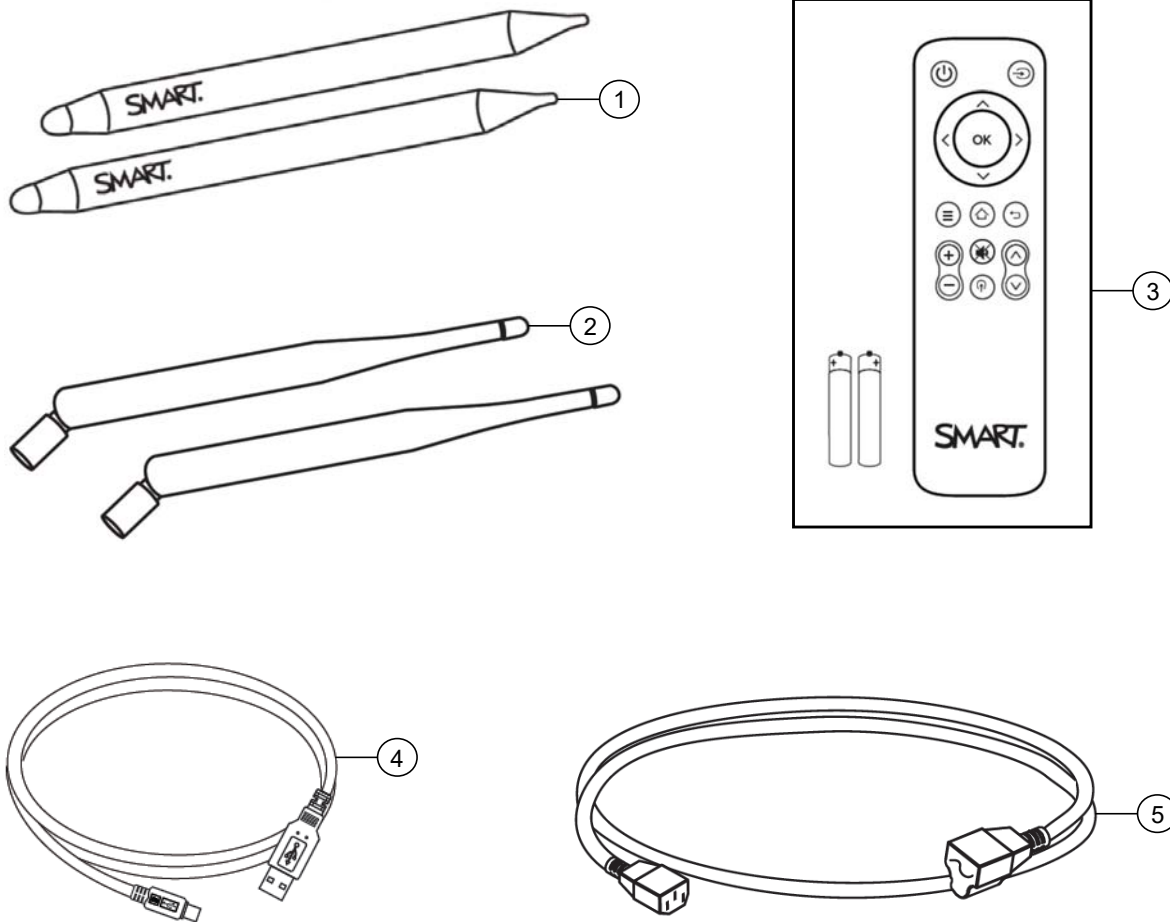

Item	Part No.	Qty	Description
1	1035246	2	Stylus, GX series
2	1038947	2	Antenna
3	1035792	1	Assembly, remote control
4	1028289	1	Cable, USB, A-B, 16' (5.0 m)
5	1022063	1	Cable, power, North America, 8' (2.4 m)
5	93-055	1	Cable, power, United Kingdom, 8' (2.4 m)
5	93-056	1	Cable, power, Australia, 8' (2.4 m)
5	93-054	1	Cable, power, Europe, 8' (2.4 m)
5	93-00708-20	1	Cable, power, China, 8' (2.4 m)
5	93-00654-20	1	Cable, power, Japan, 8' (2.4 m)
5	93-063	1	Cable, power, South Africa, 8' (2.4 m)
5	1018969	1	Cable, power, Singapore, 14' 9" (4.5 m)
5	1018970	1	Cable, power, India, 14' 9" (4.5 m)

5	1018971	1	Cable, power, Saudi Arabia, 14' 9" (4.5 m)
5	1018972	1	Cable, power, Brazil, 14' 9" (4.5 m)
5	1025597	1	Cable, power, Argentina, 14' 9" (4.5 m)
5	1025603	1	Cable, power, Chile and Italy, 14' 9" (4.5 m)
5	1030859	1	Cable, power, Korea, 8' (2.4 m)
Not shown	1038949	1	Kit, packaging, SBID-GX165-V2
Not shown	1038950	1	Kit, packaging, SBID-GX175-V2
Not shown	1038951	1	Kit, packaging, SBID-GX186-V2